

# ADJUSTABLE PEDESTAL PV 14/17

TECHNICAL  
DATASHEET

## SPECIFICATIONS

Consists of 2 pieces. The bottom piece has 8 vertical reinforcement ribs. The top piece has 8 recesses to be able to block the upper plate.

Color	Black
Support area	300 cm <sup>2</sup>
Outside diameter	215 mm
Weight	300 g/piece
Adjustable height	140-170 mm

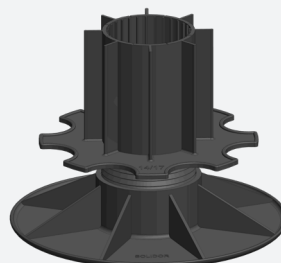

Recycled material



Weatherproof



Resistant to temperatures between  
-25 and +70°C



PP compound



Compliant with the DTU standard 43.1  
and 51.4



Capacity: 2.400 kg/m<sup>2</sup>



Tested on Broof T4 and BFL-S1

## OTHER PEDESTALS



PV 3.5/5

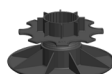

PV 8/11



PV 5/8

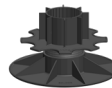

PV 11/14

## PEDESTALS WALL VERSION

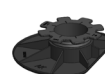

AK 3.5/5

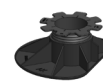

AK 5/8

## TOP PLATES

### For tiles



C2/4T



C3/4T



C6/4T



STICKSOL

### For wood



CPV+

### Other



CO

## ACCESSOIRES

### Extension piece



F30



AF100

### Slope corrector



HS2



HA5

### Fitting pieces



1 - 3 mm

## PACKAGING

### Bag

Dimensions	1.450 x 750 mm
Gross weight	13 kg
Quantity	40 pieces/bag

### Pallet

Dimensions	1.200 x 1.100 x 2.000 mm
Gross weight	166 kg
Quantity	12 pieces/bag – 480 pieces



# ADJUSTABLE PEDESTAL PV 14/17

TECHNICAL  
DATASHEET

## LOAD/M<sup>2</sup>

### Wood

Every 600 mm l/w	1.350 kg/m <sup>2</sup>
Every 500 mm l/w	2.400 kg/m <sup>2</sup>
Every 400 mm l/w	3.750 kg/m <sup>2</sup>

### Tiles

600 x 600 mm (2,25 pcs/m <sup>2</sup> )	1.350 kg/m <sup>2</sup>
500 x 500 mm (4,00 pcs/m <sup>2</sup> )	2.400 kg/m <sup>2</sup>
400 x 400 mm (6,25 pcs/m <sup>2</sup> )	3.750 kg/m <sup>2</sup>

## PRESSURE TEST (ZWICK)

1.560 kg

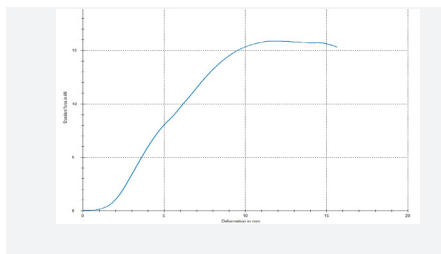

Calculation valid with correct placement and use without extension pieces. For higher construction with extension piece, these results are not valid. Minimum 1.5 threads must still be threaded into the base piece.

